



EDGE
FALL PROTECTION

Vertical Mezzanine Gate

Product Literature

Material handling is more efficient with PS DOORS Mezzanine Gates. Once installed on your mezzanine, this gate opens and closes as needed. Forklift materials to your elevated space and close the gate to protect employees from dangerous workplace falls.

Vertical Mezzanine Gate vertically opens by manual or automated operation. Activate your gate with the push of a button or a pull of a cord. Once material has been delivered to your mezzanine, the gate closes by timer or other activation device to quickly protect the mezzanine edge.

Designed to meet federal OSHA safety railing requirements.

Product Features:

- Ideal for material handling, mezzanine safety, pallet racking and loading docks
- Available in seven sizes to meet your opening width requirement
- Powder coat yellow finish, custom stainless steel finish available
- Manual, electric, pneumatic/pneumatic or pneumatic/electric operation available
- On-deck or off-deck mounting options
- 42" high gate with 4" toe board
- 120" tall vertical columns with 84" clear opening height



U.S. Patent No. 5806245

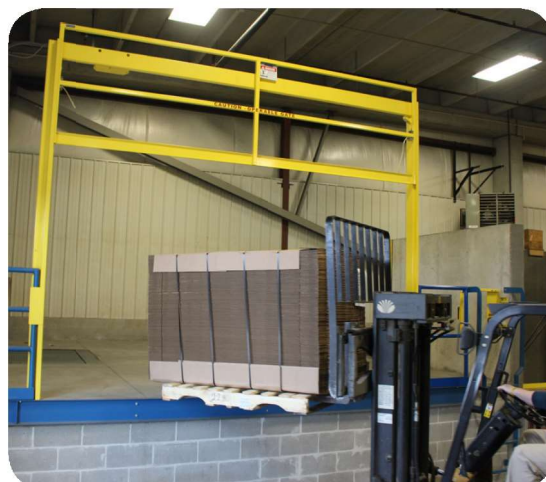
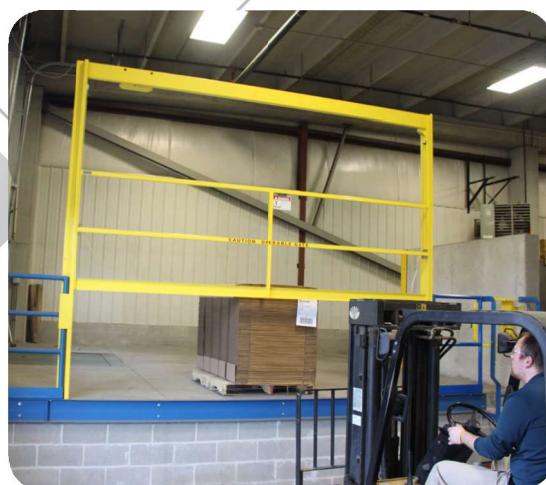

Shown: MGHEM144042



Manufactured by
PS DOORS

Rev. 120516

Vertical Mezzanine Gate

Product Literature

Standard Technical Data:

Material:

- Gate: 1-1/2" square, 11 gauge tube, factory welded. Solid horizontal top rail and mid-rail, 4" high toeboard, 42" overall height, and vertical members not to exceed 96" on center.
- Vertical Guide Column Assembly shall consist of tubular columns (120" standard length), prepped for the gate operating hardware and applicable mounting brackets. Guide assemblies shall be fabricated to allow gate to bypass idler sheaves to utilize full installation height.
- Gate Material: To be one of the following:
 - Mild Steel
 - Stainless Steel, 304-2b (contact PS DOORS for stainless steel product numbers)

Hardware:

- Gate to have a minimum of four (4) non-corrosive guide bearings, which require no lubrication.

Finish:

- Mild Steel: Powder Coat Yellow on all unfinished exposed surfaces. (Standard)
- Stainless Steel: Mill Finish/Unpainted on all unfinished, exposed surfaces (Custom).

Performance Rating:

- Gate shall meet or exceed OSHA requirements, relative to dimensions and loads, at the time of manufacture.

Installation:

- Mounting Location: Deck Mount (Standard) or Face Mount available.

Vertical Mezzanine Gate Measuring Guide

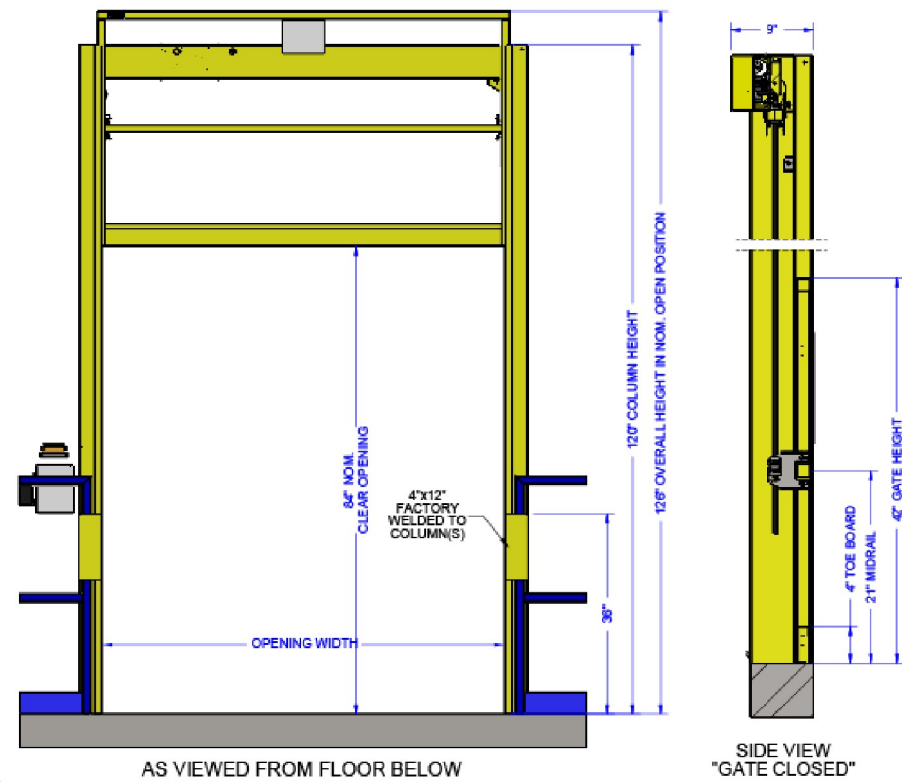

Opening Width	Operator Option	Product Number
48" (Made to order)	Manual	MGVMM048120
48" (Made to order)	Electric	MGVEM048120
48" (Made to order)	Electric/Pneumatic	MGVNM048120
48" (Made to order)	Pneumatic/Pneumatic	MGVPM048120
72" (Stocked Size)	Manual	MGVMM072120
72" (Stocked Size)	Electric	MGVEM072120
72" (Stocked Size)	Electric/Pneumatic	MGVNM072120
72" (Stocked Size)	Pneumatic/Pneumatic	MGVPM072120
96" (Stocked Size)	Manual	MGVMM096120
96" (Stocked Size)	Electric	MGVEM096120
96" (Stocked Size)	Electric/Pneumatic	MGVNM096120
96" (Stocked Size)	Pneumatic/Pneumatic	MGVPM096120
120" (Made to order)	Manual	MGVMM120120
120" (Made to order)	Electric	MGVEM120120
120" (Made to order)	Electric/Pneumatic	MGVNM120120
120" (Made to order)	Pneumatic/Pneumatic	MGVPM120120
144" (Made to order)	Manual	MGVMM144120
144" (Made to order)	Electric	MGVEM144120
144" (Made to order)	Electric/Pneumatic	MGVNM144120
144" (Made to order)	Pneumatic/Pneumatic	MGVPM144120
168" (Made to order)	Manual	MGVMM168120
168" (Made to order)	Electric	MGVEM168120
168" (Made to order)	Electric/Pneumatic	MGVNM168120
168" (Made to order)	Pneumatic/Pneumatic	MGVPM168120
192" (Made to order)	Manual	MGVMM192120
192" (Made to order)	Electric	MGVEM192120
192" (Made to order)	Electric/Pneumatic	MGVNM192120
192" (Made to order)	Pneumatic/Pneumatic	MGVPM192120

* Custom sizing and design available. Mild Steel product numbers shown.

